

## INDEX

<b>1</b>	PACKAGE CONTENT	12
<b>2</b>	MECHANICAL AND ACOUSTICAL FEATURES	13
<b>3</b>	CONFIGURATION OPTIONS	13
<b>4</b>	CONTROL PANEL	14
<b>5</b>	MAINS	16
<b>6</b>	BLUETOOTH® CONNECTION	17
<b>7</b>	QUICK SETUP	17
<b>8</b>	ACCESSORIES	18
<b>9</b>	INSTALLATION EXAMPLES	18
<b>10</b>	TROUBLESHOOTING	19
<b>11</b>	TECH SPECS	20

### **1** PACKAGE CONTENT

- 1 x B Series speaker
- 1 x User Manual – Section 1
- 1 x User Manual – Section 2
- 1 x Mains cable, specific for your area

The warnings in this manual must be observed together with the "USER MANUAL - Section 2".

*Thank you for purchasing a Montarbo product, the Italian company founded in 1962, and since then serving music and audio. The unique and state of the art Montarbo products are designed with the utmost attention to detail and durability. Reliability is in line with the high quality standards and sensitivity to the environmental impact that distinguish the company.*

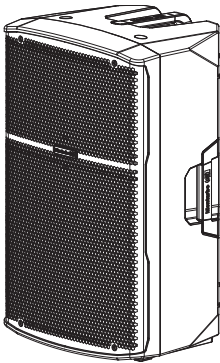

**B series active speakers are versatile, ergonomic and portable. Suitable for PA use in small and medium venues, they are equipped with a mixer with three inputs for all kind of sources, including signals via Bluetooth® from devices such as smartphones and tablets. A DSP with 4 presets adapts the acoustic performance to different applications.**

## 2 MECHANICAL AND ACOUSTICAL FEATURES

The speakers are equipped with a high frequencies compression driver (1" for B108, 1.35" for the other models) and an 8", 10", 12", and 15" drivers respectively for B108, B110, B112 and B115 models. The design integrates 3 handles, as well as a flange for pole fixing. On B110, B112, and B115 models, it is possible to select the inclination (0° / 7.5°). In addition to this, two sides of the cabinet with 40° inclination allow the use as a stage monitor. Furthermore, for each model are also available as accessories optional covers for transport and rapid protection from the weather.

## 3 CONFIGURATION OPTIONS

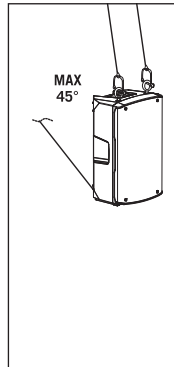
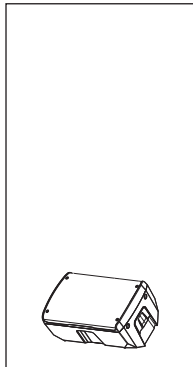
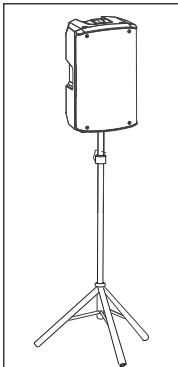

**FOR FURTHER INFORMATION,  
REFER TO CHAPTER 9**

**4 CONTROL PANEL**

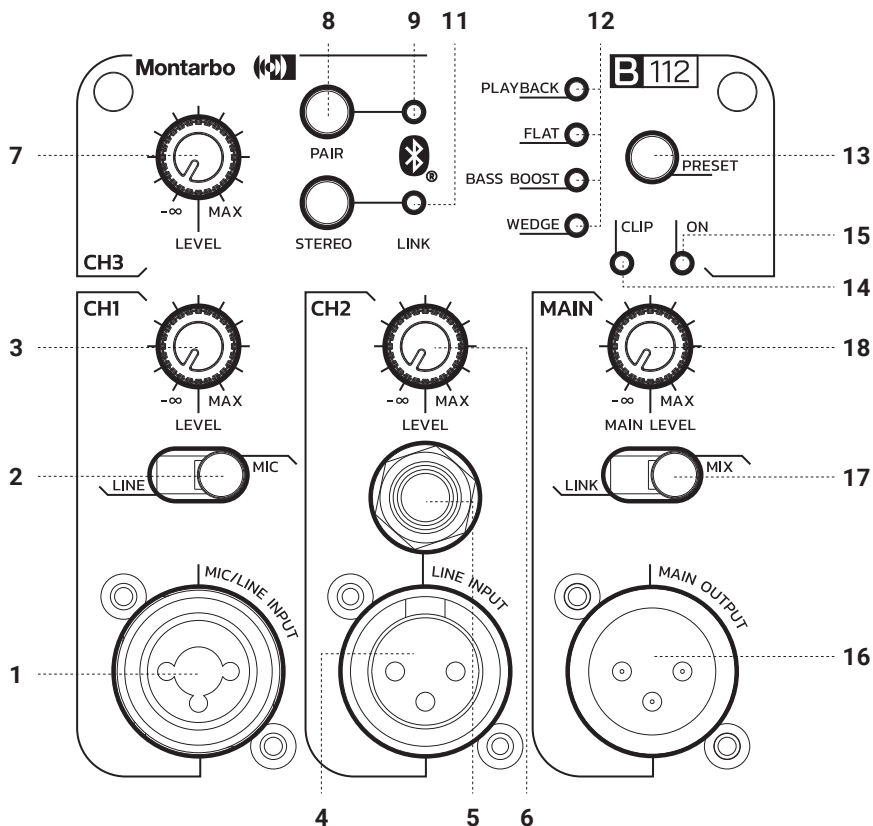

**1 MIC/LINE INPUT**

Combo socket (XLR-F + 6,35mm. - 1/4" jack) for microphone and line signals.

**2 LINE/MIC SWITCH**

Use this switch to choose input sensitivity.

**3 LEVEL CH1**

This knob adjusts channel 1 level. Turn the knob clockwise to increase volume, or counterclockwise to lower it.

**4 LINE INPUT**

XLR-F input socket for line level signals.

**5 LINE INPUT**

6,35mm. (1/4") for line level signals.

## 6 LEVEL CH2

This knob adjusts channel 2 level. Turn the knob clockwise to increase volume, or counterclockwise to lower it.

## 7 LEVEL CH3

This knob adjusts channel 3 level. Turn the knob clockwise to increase volume, or counterclockwise to lower it.

## 8 PAIR

Button to synchronize and connect mobile phones or tablets. For the procedure, see chapter 6 Bluetooth® CONNECTION.

## 9 LED PAIR

Status indicator LED for Bluetooth® connection. It flashes while synchronizing the speaker with the mobile device, and it's steadily lit during the connection.

## 10 AUX INPUT

Unbalanced input with 3.5mm stereo socket for wired connection with external devices (PC, smartphone, tablet, etc.).

## 11 LINK

This led is steadily lit during audio streaming.

## 12 PRESET LEDS

These LEDs indicate which preset is active among PLAYBACK, FLAT, BASS BOOST and WEDGE.

These presets have been optimized for different applications. PLAYBACK is ideal for recorded audio listening and/or karaoke, FLAT is ideal for concerts, BASS BOOST is ideal for reproduction of audio rich of low frequencies, such as DJing and disco music, while WEDGE is suited for use as a monitor stage.

## 13 PRESET

This selector allows to choose among the four presets the best one for the current application.

## 14 CLIP LED

This LED lights up when the speaker signal is close to distortion. In this case, reduce both the MAIN signal and those of the active channels.

## 15 ON LED

This LED lights up when the speaker is connected to the mains and the power switch is ON.

## 16 LINE OUTPUT

This XLR-M output provides a balanced line level signal, the output signal is set by the related selector.

## 17 LINK/MIX

Use this selector to choose the output signal towards another speaker. The choice is between the input signals (LINK) or the mix between the three input channels as controlled by the MAIN (MIX).

## 18 MAIN LEVEL

This knob adjusts active speaker output level.

## 5 MAINS

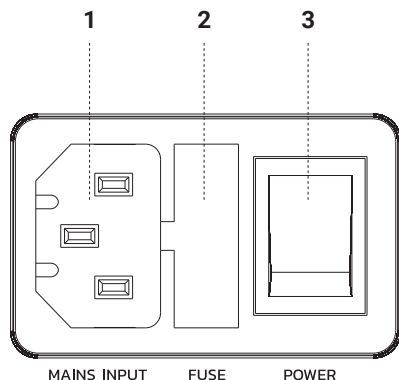

- 110-120V~ 50-60Hz 3A (T6,3A L 250V~)
- 220-240V~ 50-60Hz 1,8A (T3,15A L 250V~)

**Internal voltage setup**  
 (Replace fuse with same ratings)  
 (Remplacer le fusible avec le même type)



DO NOT COVER, KEEP IT CLEAN!

**"CAUTION"**  
 RISK OF  
 ELECTRICAL  
 SHOCK  
 DO NOT OPEN

**"ATTENTION"**  
 RISQUE DE  
 CHOCH  
 ELECTRIQUE  
 NE PAS OUVRIR

**FC** ~~CE~~ **EAC**  
 MADE IN CHINA

**AEB INDUSTRIALE S.R.L.**  
 Via Brodolini, 8  
 Località Crespellano  
 40053 VALSAMOGGIA (BO)  
 ITALY

SERIAL N.

### 1 MAINS INPUT

IEC input socket with integrated mains filter. Each package is supplied with the necessary power cable, specific for your area. With the speaker turned off, insert the power cable into this socket. For your own safety, never disconnect the earth plug.

### 2 FUSE

Protection fuse.

**CAUTION:** Replace the fuse only with one of the same type and with the same value. If the fuse blows repeatedly, contact an authorized service center.

### 3 POWER ON/OFF

Use this switch to turn ON/OFF the unit.

## 6 BLUETOOTH® CONNECTION

- Make sure the device to be synchronized with the speaker is turned on and ready to be connected via Bluetooth®. With the speaker on, press the PAIR button to activate Bluetooth® synchronization. The related green LED flashes.
- Check on the mobile device that the name of the speaker – e.g. B108 - appears among the available devices.
- Select the speaker model to synchronize the device. The perfect connection is indicated by the relative LED remaining lit.
- Now adjust CH3 and MAIN levels for the desired playback volume of songs chosen in synchronized device.

## CONNECTION TO THE SECOND SPEAKER

- On the first speaker, already synchronized, keep the STEREO button pressed for few seconds. The blue LINK led starts flashing.
- Turn on the second speaker and press its PAIR button, its relevant LED starts flashing. After synchronization, both the LINK LED of the first speaker and the PAIR LED of the second speaker remain lit.
- Adjust second speaker LEVEL CH3 and MAIN; the signal from the source device is output from both speakers.

## 7 QUICK SETUP

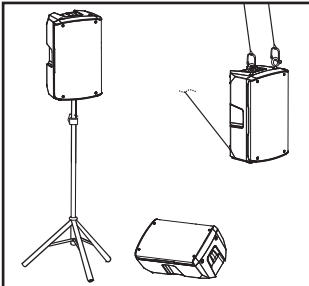

Place the speaker according to the installation choice

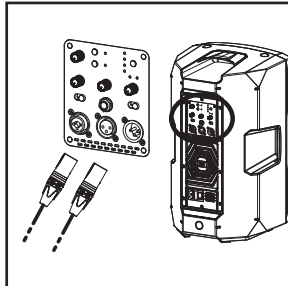

Connect the audio sources to the inputs (channel levels zeroed)

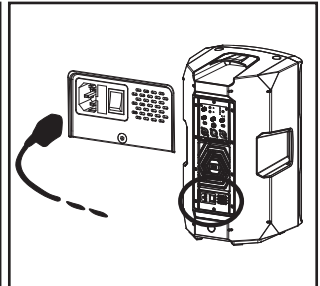

Insert the mains cable and turn on the speaker

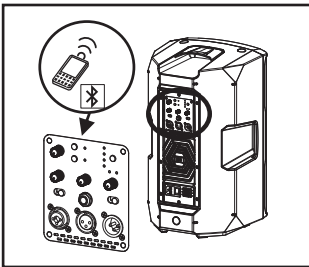

Switch on and pair the Bluetooth®

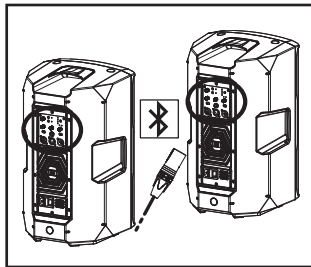

Connect additional speakers (via Bluetooth® or via cables)

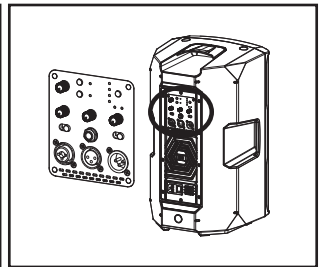

Adjust all volumes as desired

## 8 ACCESSORIES

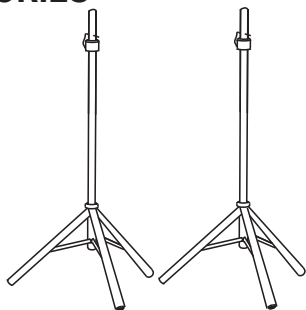

Tripod stand kit

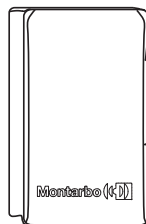

CV-B108/B110/B112/B115 cover

## 9 INSTALLATION EXAMPLES

The placement is intuitive. For the diffusion towards a seated or standing audience, the use of certified placed on a flat surface and with mains and signal cables placed in such a way that they cannot be walked on, nor are they stretched, or they can cause a stumble or poor safety.

### INSTALLATION ON TRIPOD STAND

The speaker can be installed on an optional tripod stand with a standard 35mm diameter pole. The maximum height allowed between the speaker base and the floor is 170 cm (5.57ft)

### WEDGE INSTALLATION

The speaker can be placed, using the cabinet angle, as a live monitor. In this case it is suggested to select the WEDGE preset on the control panel.

### INSTALLATION WITH EYEBOLTS

The speaker can also be installed using eyebolts. The positioning is shown in the figure on the side, where the rear eyebolt allows adjusting the final angle (MAX 45°).

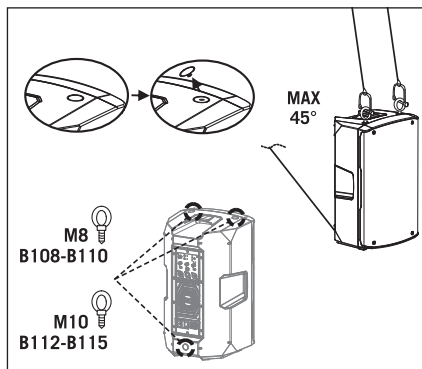
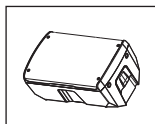
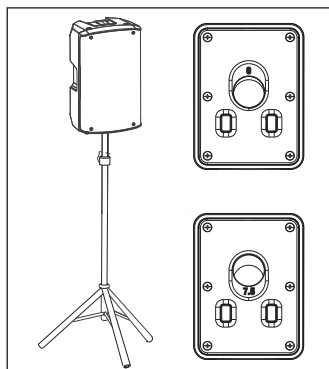

## 10 TROUBLESHOOTING

### The speaker does not turn on

- The speaker does not turn on
- Check for the correct power supply upstream of the system.
- Check that the power cable with VDE connector is correctly inserted.

### The speaker turns on but makes no sound

- Check audio channels (CH1, CH2 and/or CH3) proper input connections.
- Check that the cables used are properly working. Use only good quality cables in good condition.
- Check that audio sources are turned on and indicate the output signal.
- Check CH1 input proper sensitivity.
- Check CH1 proper synchronization of the Bluetooth® signal.
- Check MAIN output level.

### The speaker outputs poor or distorted sound:

- Adjust the source volume appropriate of mixer section inputs.
- Check that the cables used are not damaged. Use only good quality cables in good condition.
- Check inputs and MAIN volume levels.
- Check the associated Bluetooth® device output signal.
- Cut the level of the MIC, LINE and/or MAIN inputs.
- Make sure you have not connected a line signal to channel 1 with MIC sensitivity.

### Background noise

- Turn off the power and disconnect all connected devices.
- By connecting one device at a time, check the signal from each source to find out which one caused the problem.

## 11 TECH SPECS

MODEL	B108	B110	B112	B115
<b>System type</b>	2-way bass reflex	2-way bass reflex	2-way bass reflex	2-way bass reflex
<b>MAX SPL (@ 1m)</b>	125 dB	126 dB	129 dB	130 dB
<b>Frequency response (-10 dB)</b>	68Hz-20KHz	60Hz-20KHz	54Hz-20KHz	50Hz-20KHz
<b>Frequency response (-6 dB)</b>	73Hz-19KHz	64Hz-19KHz	57Hz-19KHz	55Hz-19KHz
<b>HF</b>	1" (25mm) driver	1.35" (34mm) driver	1.35" (34mm) driver	1.35" (34mm) driver
<b>LF</b>	8" - 2" V.C (50mm)	10" - 2" V.C (50mm)	12" - 2.5" V.C (65mm)	15" - 2.5" V.C (65mm)
<b>Coverage (H x V)</b>	90° H x 60° V	90° H x 60° V	90° H x 60° V	90° H x 60° V
<b>Crossover frequency</b>	2,1 kHz	1,8 kHz	1,8 kHz	1,8 kHz
<b>Amplifier class</b>	D + A/B	D + A/B	D	D
<b>RMS Power</b>	200 W	200 W	600 W	600 W
<b>Peak Power</b>	400 W	400 W	1200 W	1200 W
<b>Cooling</b>	Convection	Convection	Fan	Fan
<b>Mains</b>	110-120V~ 50-60Hz 220-240V~ 50-60Hz	110-120V~ 50-60Hz 220-240V~ 50-60Hz	110-120V~ 50-60Hz 220-240V~ 50-60Hz	110-120V~ 50-60Hz 220-240V~ 50-60Hz
<b>Operating ambient temperature</b>	-20° +45°	-20° +45°	-20° +45°	-20° +45°
<b>DSP</b>	28/56 bit	28/56 bit	28/56 bit	28/56 bit
<b>Advanced functions</b>	FIR filters	FIR filters	FIR filters	FIR filters
<b>AD/DA converter</b>	24 bit, 48 kHz	24 bit, 48 kHz	24 bit, 48 kHz	24 bit, 48 kHz
<b>Bluetooth®</b>	5.0 (stereo)	5.0 (stereo)	5.0 (stereo)	5.0 (stereo)

<b>Connettori I/O</b>	CH1: Combo CH2: XLR-F + jack 6,35mm (1/4") AUX IN: mini-jack 3,5mm LINE OUT: XLR-M	CH1: Combo CH2: XLR-F + jack 6,35mm (1/4") AUX IN: mini-jack 3,5mm LINE OUT: XLR-M	CH1: Combo CH2: XLR-F + jack 6,35mm (1/4") AUX IN: mini-jack 3,5mm LINE OUT: XLR-M	CH1: Combo CH2: XLR-F + jack 6,35mm (1/4") AUX IN: mini-jack 3,5mm LINE OUT: XLR-M
<b>Controls</b>	Ch levels MAIN level PRESET button Channel sens. LINK/MIX selection	Ch levels MAIN level PRESET button Channel sens. LINK/MIX selection	Ch levels MAIN level PRESET button Channel sens. LINK/MIX selection	Ch levels MAIN level PRESET button Channel sens. LINK/MIX selection
<b>Fuse</b>	T5A L 250V~ T2,5A L 250V~	T5A L 250V~ T2,5A L 250V	T6,3A L 250V~ T3,15A L 250V~	T6,3A L 250V~ T3,15A L 250V~
<b>Absorption at 1/8th of power (average use conditions):</b>	0.6 A (110-120V~) 0.39 A (220-240V~)	0.6 A (110-120V~) 0.39 A (220-240V~)	1.47 A (110-120V~) 0.89 A (220-240V~)	1.47 A (110-120V~) 0.89 A (220-240V~)
<b>Absorption at 1/3th power (maximum use conditions):</b>	1.1 A (110-120V~) 0.85 A (220-240V~)	1.1 A (110-120V~) 0.85 A (220-240V~)	3 A (110-120V~) 1.8 A (220-240V~)	3 A (110-120V~) 1.8 A (220-240V~)
<b>Idle absorption:</b>	19 W	19 W	19.2 W	19.2 W
<b>Inrush current:</b>	15,8 A	15,8 A	6,3 A	6,3 A
<b>Cabinet:</b>	Polypropilene	Polypropilene	Polypropilene	Polypropilene
<b>Dimensions (L x H x P):</b>	250 x 430 x 237 mm (9.8" x 16.9" x 9.3")	310 x 524.5 x 280 mm (12.2" x 20.6" x 11")	365 x 625 x 345 mm (14.4" x 24.6" x 13.6")	430 x 725 x 405 mm (16.9" x 28.5" x 15.9")
<b>Weight:</b>	8.5 kg (18.74 lb)	11.3 kg (24.92 lb)	17.9 kg (39.46 lb)	21.6 kg (47.62 lb)
<b>MODEL</b>	<b>B108</b>	<b>B110</b>	<b>B112</b>	<b>B115</b>